

# Installation Instructions

## SAUNA ROOM

**WOODBIDGE®**

**Model:CSQ-3247-A**



**SCAN  
ME**

**To Activate  
Warranty**



**SAUNA ROOM  
FOR INDOOR USE ONLY  
120VAC 15 AMP DEDICATED CIRCUIT**



**READ ALL INSTRUCTIONS BEFORE UNPACKING THE PRODUCT**

INSTRUCTIONS THAT, IF IGNORED COULD RESULT IN DEATH OR SERIOUS INJURY CAUSED BY INCORRECT HANDLING OR INSTALLATION OF THE PRODUCT. THESE INSTRUCTIONS MUST BE OBSERVED FOR SAFE INSTALLATION.

**HEAVY!**



**TEAM LIFTING  
REQUIRED**

**TEAM ARE REQUIRED TO LIFT AND DURING  
ENTIRE INSTALLATION OF THIS PRODUCT**

It is strongly recommended that this product be installed by a fully insured and licensed installer.

We are not responsible for local code compliance for this product. Building and plumbing codes may vary from state-to-state in accordance to your location. We are not responsible for providing any compliance certifications.

Under no circumstances we are liable for any and all incidental damages sustained in connection with this product. Neither manufacturer, distributor or retailer is responsible for water damage or flood caused by the usage of this product.

Under no circumstances we are liable for any and all fees, cost of installation/reinstallation/removal, subsequent damages or transportation in case of the product defect.

The connection instructions in this manual are for general reference. The actual connections may vary by the type of sauna room you purchase.

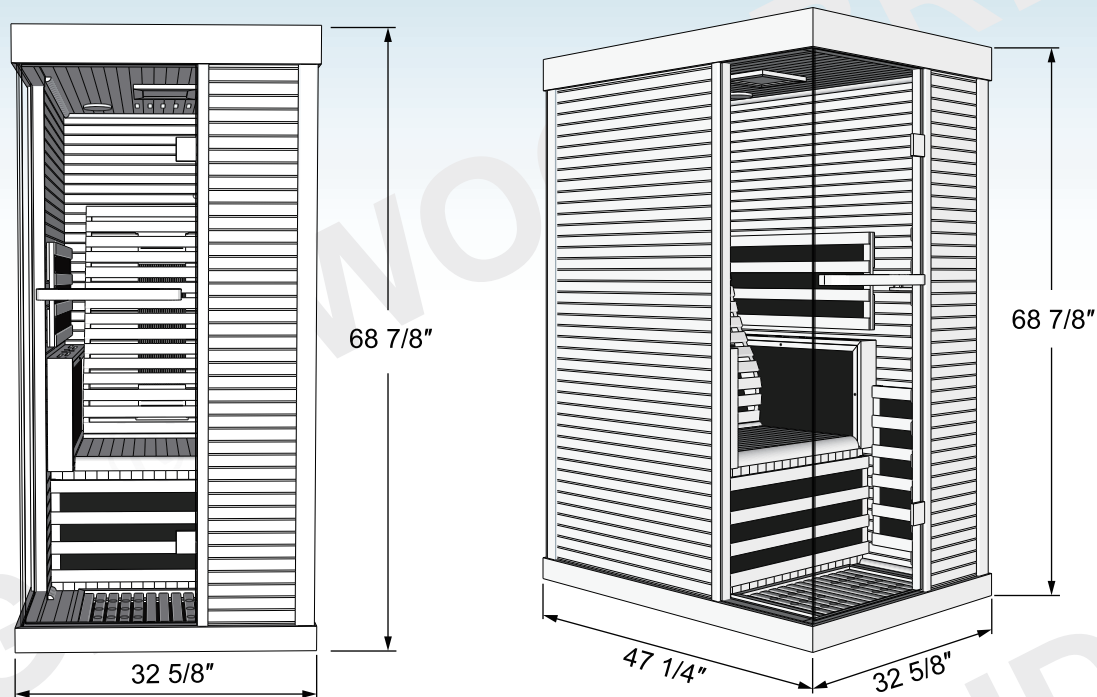

## CONTENTS

- |                         |                     |
|-------------------------|---------------------|
| A. Preview              | F. F.A.Q.           |
| B. General Safety Rules | G. Maintenance      |
| C. Installation         | H. Transportation   |
| D. Operation            | I. Limited Warranty |
| E. Tips for Use         |                     |

## WARNING

Visually inspect all heaters before assembling to make sure there's no damages!  
Contact your dealer or manufacturer for troubleshooting and replacement parts.

## NOTE

The pictures and diagrams shown are representations of this model. Some models may vary. Due to excessive vibrations during transportation can cause damage to the heating elements. If there's any visible damage do not start the sauna.  
Safety notes/warnings included in this manual. Be aware of the safety notices on the sauna itself.

Choose an installation location for your indoor sauna:

- (1) Your sauna should be placed on a solid surface and dry area.
- (2) Your sauna should not be built into any structure. It is a self-contained and freestanding unit.
- (3) To allow easy access to the main power cord, ensure there's a minimum of 3 inches of clearance from the top wall and all sides of the unit.
- (4) Moisture may cause damage to the interior and exterior of your sauna. Your basement, attic, garage, playroom, spare bedroom, new extension, and garden chalet are a few possible locations for your sauna.

### Cleaning & maintenance

1. Before using your Infrared Sauna for the first time, use a damp cloth to clean the inside of the sauna. You can use a natural furniture polish, or beeswax to clean the exterior.
2. To burn off any factory dust before using your sauna for the first time, turn the sauna on for the maximum time and temperature. Turn on to max temperature and run for at least one hour.
3. Remove any scratches and stains on the inside of the sauna using fine-grade sandpaper over the damaged area.
4. We recommend applying a heavy furniture polish or beeswax to the outside of the sauna and this polish will create a barrier for better protection.

## A. PREVIEW

### A.1 Operating Conditions:

- Temperature: 5°C-40°C (Fahrenheit Degree: 41-104°F)
- Humidity: W85%
- Pressure: 700-1060 hpa
- Power supply: AC115-120V, 60Hz
- The sauna cabin must be 1.38 inches away from the wall at minimum.

### A.2 Features:

- Wooden construction.
- Digital microprocessor controlled.
- Temperature adjustable from 30°C-65°C. (Fahrenheit Degree: 86-149°F)
- Adjustable dwell time from 1 to 90 minutes.
- Temperature sensor.
- Touch-tone keypad.
- Long-life carbon fiber heater.
- One vent on top.

Before using the sauna, familiarize yourself with all.

## B.GENERAL SAFETY RULES

### B.1 IT IS ILLEGAL TO INSTALL THIS UNIT WITHOUT FIRST OBTAINING A PERMIT FROM THE LOCAL ELECTRICAL INSPECTION AUTHORITY.

- There must be a reliable grounding device in the power supply and circuit used when the equipment is working, a reliable grounding wire in the socket to avoid a large amount of water vapor produced by the equipment due to overuse, which may cause static induction, voltage increase, short circuit, smoke, tripping and other hazards;
- equipment used in the work of the power cord and circuit connection line hidden inside the device, do not pull the wire in the process of use or to change lines, please do not rub back and forth around the foot mesh or heating plate to avoid grinding equipment wires and circuit connections outside the protective layer, resulting in power leakage, wire short circuit, smoke, tripping and other hazards;
- Do not use the national standard voltage other than the power supply, so as not to cause fire and electric shock hazards.
- Do not attach moisture or any debris to the power plug or the gap between the power supply, so as to avoid electric shock or other equipment failure;
- When plugging in or unplugging from the power supply, please grasp the plug and make sure there is no moisture on your hands to avoid the risk of electric shock;
- Families with pets need to pay attention to the pet's behavior to avoid them biting the power cord to avoid causing a fire or other accidents; when out of the house, be sure to unplug the power plug, and place the equipment in an area that pets can not reach.

### B.2 Health Precaution

HIGH HEAT HAZARD: Normal body temperature should not exceed 39°C(103°F).

- Do not sleep while using the equipment to avoid accidents; do not use the equipment continuously for a long period of time;
- Only use equipment under a responsible adult supervision;
- If you feel uncomfortable or your skin feels abnormal during usage, please stop using the device immediately and consult a doctor;
- Don't wear clothes with metal and remove metal jewelry when using the device to avoid low temperature burns.

**CAUTION: If you feel dizzy, drowsy or have any symptoms of discomfort, exit the sauna immediately. If you are experiencing symptoms of discomfort or illness, you must consult your physician before using the sauna. Please note that this product is a physical therapy device and not a treatment device.**

### B.3 Safety Precautions

- Do not dry clothes or leave towels in the sauna.
- Do not touch the heater with your fingers or metal tools when the light is on.
- Do not splash water or other liquids on the heater.
- Do not use the sauna if you have any of the following conditions:
  1. Open wounds, eye problems or severe burns;
  2. Seniors, special needs or disabilities, pregnant and small children;
  3. Patients suffering from hyperthermia, obesity, heart disease, high blood pressure, circulatory diseases or diabetes must consult a doctor before using this product.
- No pets.
- Do not use after excessive alcohol consumption.
- Do not install sauna near water, bathtubs, showers, wet basements or swimming pools.
- Do not use liquid cleaners or aerosol cleaners in the sauna. Before cleaning, it is necessary to disconnect the power and unplug the outlet. Scrubbing with water and a soft cloth is recommended.
- If it is necessary to use a wall outlet adapter or extension cord between the sauna power cord and the wall outlet, use a product that complies with the standard regulations.
- Children 8 years of age and older, and a person with special needs or disabilities must be supervised at all times by a guardian the safe use of electrical appliances before using this product.
- The sauna should be inspected before restarting the timer.
- When replacement parts are required, make sure they meet the manufacturer's specified requirements.
- Unauthorized substitutions may result in fire, electric shock or other hazardous conditions. After performing any repairs, have a service technician perform a safety check.

### B.4: Maintenance Guidelines

- To ensure the best performance and safety of your sauna, please review the following guidelines:
- **DO NOT MODIFY THE POWER CORD:** The power cord supplied with your product is designed for safe operation. Modifying, cutting or altering the power cord in any way may result in a safety hazard.
- If the power cord is damaged, it must be replaced by a similarly qualified person in order to avoid a hazard.
- **WARNING:** It is strongly recommended that all power connections be carried out by a qualified electrician.
- **Avoid the use of extension cords:** We strongly recommend that you do not use extension cords with this product. Extension cords may cause a drop in the power supply, leading to reduced performance and potential safety risks. If you need a longer extension, please contact our customer service for a recommended solution.
- When replacement parts are required, make sure they meet the manufacturer's specified requirements.
- Unauthorized substitutions may result in fire, electric shock or other hazardous conditions. After any repair, have a service technician perform a safety check to make sure your sauna is working properly.
- Failure to follow these instructions may result in damage to the product or pose a safety risk. Thank you for prioritizing safety and following these guidelines.

## MAIN COMPONENTS

1 	2 	3 	4 	5 	6 
BASE PLATE	BACK PANEL	LEFT PANEL +HEATER	RIGHT PANEL +HEATER	TOP PANEL	FRONT PANEL WITH GLASS DOOR
7 	8 	9 	10 	11 	12 
SEAT SUPPORT	SEAT PANEL	BACKREST	DUST COVER	WOODHANDLE	OXYGEN BAR
13 					
TEA CUP HOLDER					

## FIXINGS, FITTINGS AND TOOLS

				
M3.5*15MM	M3.5*25MM	M4*50MM	M4*40MM	M6*40MM
SCREW FOR OXYGEN BAR AND DUST COVER PLATE QTY:12	SCREW FOR TEA CUP HOLDER QTY:2	SCREW FOR BENCH AND LEG SUPPORT QTY:8	SCREW FOR BACKREST QTY:2	SCREW FOR WOOD HANDLE QTY:2
SPARE SCREWS QTY:4	SPARE SCREWS QTY:4	SPARE SCREWS QTY:4	SPARE SCREWS QTY:4	

# C.INSTALLATION

## C.1 Product explosion diagram and heating element layout.

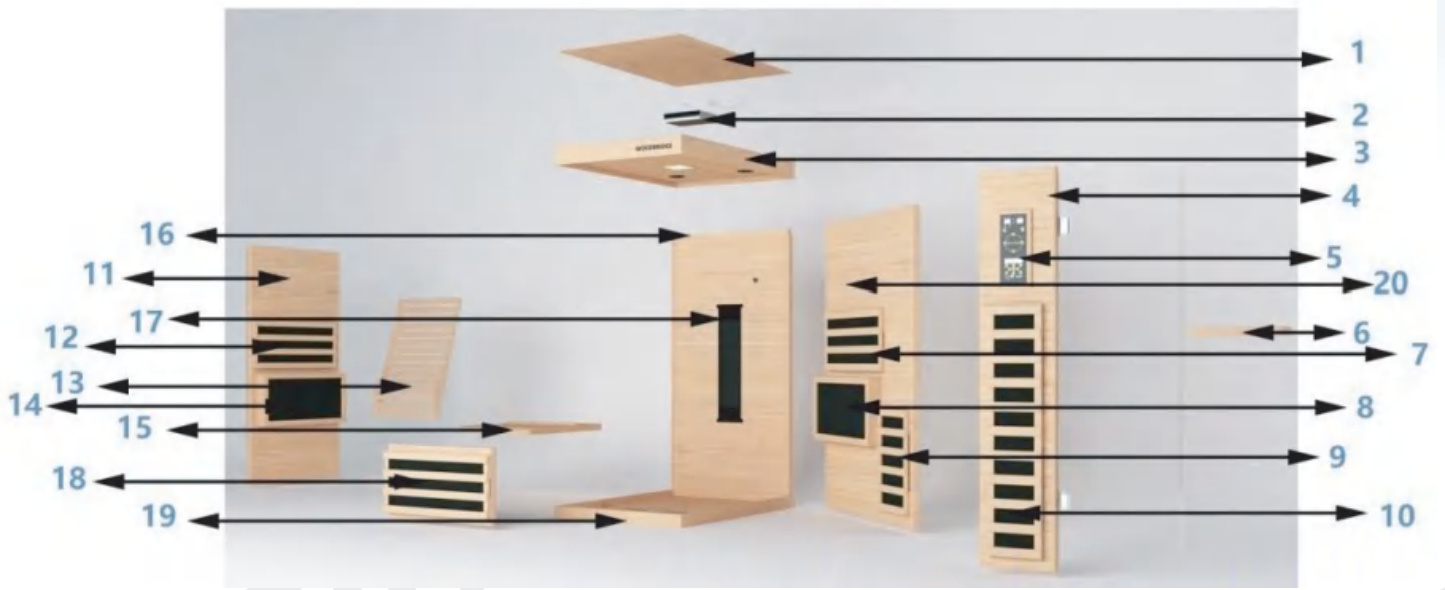

1	Dust Cover	2	Power Supply Box	3	Top Panel	4	Front Panel with Glass Door
5	Controller Panel	6	Wood Handle	7	Right Panel Heater	8	Seat Right Panel Heater
9	Seat Front Right Panel Heater	10	Seat Front Panel Heater	11	Left Panel Side glass	12	Left Panel Heater
13	Backrest	14	Seat Left Panel Heater	15	Seat Panel+Heater	16	Back Panel
17	Back Panel Heating Tube	18	Seat Support+Heater	19	Base Plate+Heater	20	Right Panel

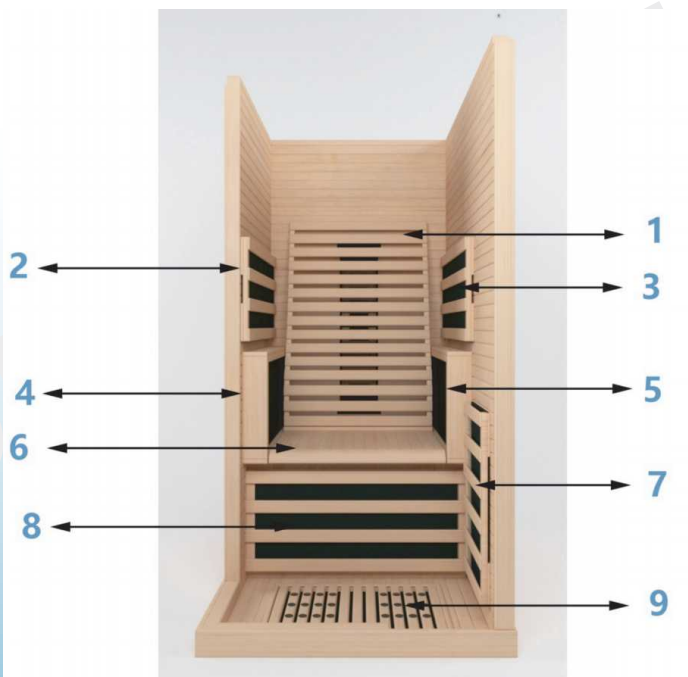

1	Back Panel Heating Tube 0.4"*22.6"*1PC	2	Left Panel Heater 27.6"*11.8"*1PC
3	Right Panel Heater 27.6"*11.8"*1PC	4	Seat Left Panel Heater 27.6"*11.8"*1PC
5	Seat Right Panel Heater 27.6"*11.8"*1PC	6	Seat Panel+Heater 19.7"*11.8"*1PC
7	Seat Front Right Panel Heater 39.4"*7.9"*1PC	8	Seat Support+Heater 27.6"*11.8"*1PC
9	Foot+Foot Heater 19.7"*11.8"*1PC		

# Assembly diagram



Step 1: Install Bottom



Step 2: Install Back Panel



Step 3: Install Left panel



Step 4: Install Right Panel



Step 5: Install Seat Support



Step 6: Install Plug



Step 7: Install Seat



Step 8: Install Backrest

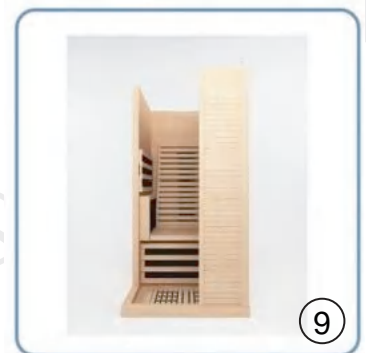

Step 9: Install Front Panel



Step 10: Install glass door and Side glass



Step 11: Install Top Panel



Step 12: Install Wood Handle

## C.2 Circuit Diagram

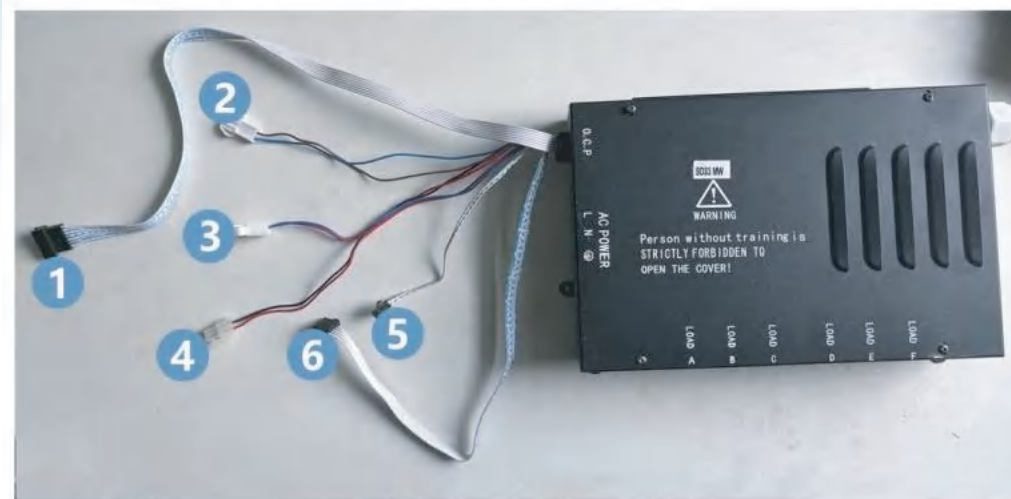

1	Control Line	2	Backup Line	3	Backup Line
4	Oxygen Bar Line	5	Temperature Sensor	6	Color Light

This circuit diagram is applicable to (FOR CARBON ENERG INFRARED MODEL SAUNAS)

## C.3 Attention before installation

- Do not share the same plug with other appliances.
- Position it on a flat level surface.
- Do not splash the exterior with water. If the floor is damp, install a floor separator to keep the sauna dry & high.
- Do not store the flammable objects or chemical substances near the sauna.

## C.4 Details during installation

- Place the Bottom Panel on level ground and keep the right the side up.



- Fasten the sauna plate with hasp.

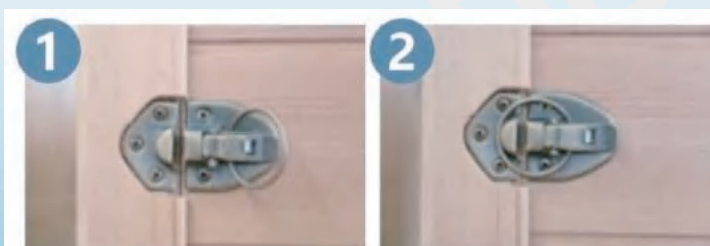

• Leg Support Install(Screw Fixed)



M4\*50MM

SCREW FOR LEG SUPPORT  
QTY:4

• Seat Install(Screw Fixed)



M4\*50MM

SCREW FOR BENCH  
QTY:4

• Seat Backrest(Screw Fixed)



M4\*40MM

SCREW FOR BENCH  
QTY:2

• Install Top(Screw Fixed Top+Electric Connection)

Open Dust Cover Plate and Install the top on the sauna room

Open components(Top Panel)and(Dust Cover Plate)



Install Heater Plug



Install Power Box connection terminal



Install Dust Cover Plate

Install components(Top Panel)and(Dust Cover Plate)



- Installing cup holder.

Attach cup holders in the fore left corner and the fore right corner(when sitting in the sauna).



- Installing doorknob.

1.Align the inside doorknob against holes on the inside of the door.

2.Hold it at an angle against the door.

3.Insert the screw into the hole located on the inside of the door. Screw until it is tightly fit.

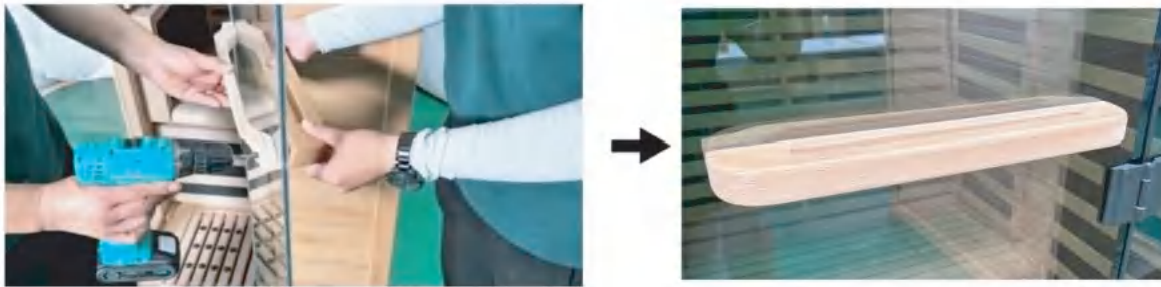

## C.5 How to replace the heater

**Warning: only qualified person can replace the heater.**

- How to replace the carbon fiber heater:



1. Take off wooden frame of carbon heater, then screw off carbon heater from wooden frame.

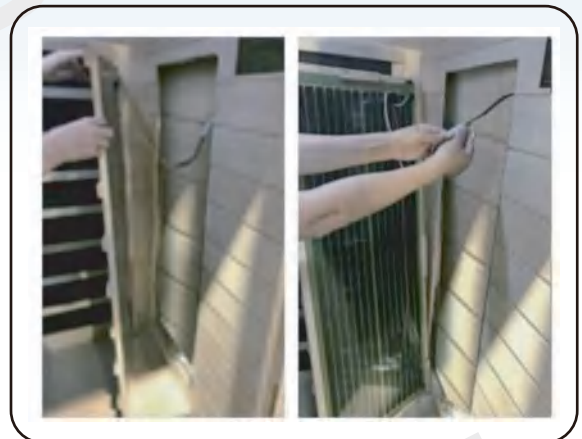

2. Take out carbon heater carefully. Find out the connector between carbon heater and sauna wall.

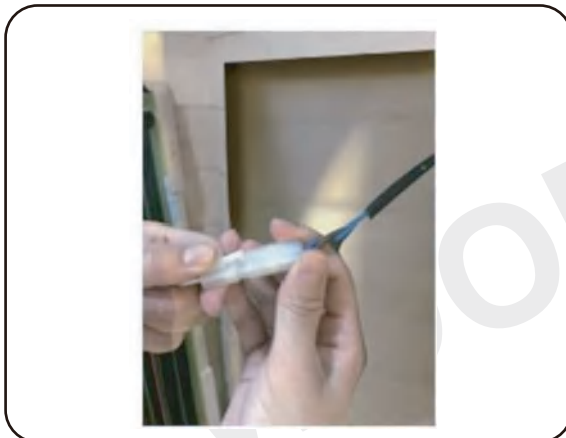

3. Disconnect the connector between carbon heater and sauna wall.



4. Replace with a new carbon heater. Screw it into wooden frame. Then plug in the connector from carbon heater and sauna wall.

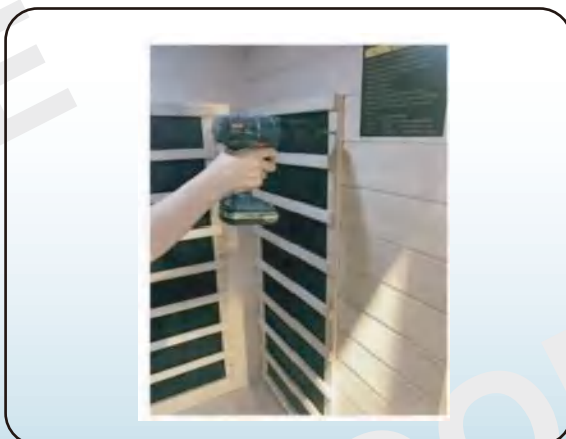

5. Screw wooden frame of carbon heater to sauna wall and cover the screw hole with original wooden cover.

- How to replace the carbon tube(Example: The following picture shows other products, but the replacement method is the same)

a.Remove the 2 fixed screws from the wooden fence.



b.Remove the screws from the black mesh cover and remove the mesh cover.

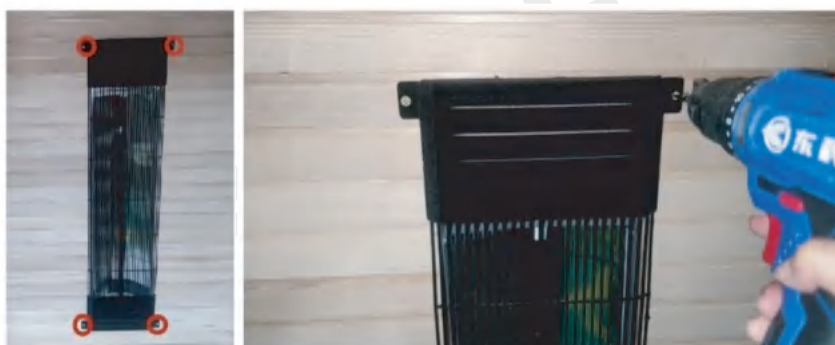

c.Pull out the wire connectors on both sides of the heating element from the inside of the sauna room (do not forcefully pull to prevent breakage, you can hold the white wire and shake it left and right to pull it out), cut off the connecting wire of the heating element.



d. Remove the metal wire clips from both ends of the heater and remove the damaged heating tube.



e. Install a new heating tube and insert the line card.

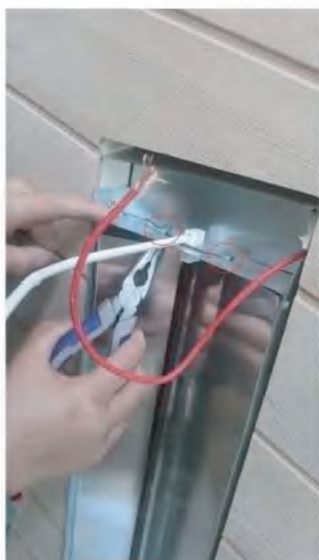

f. Connect the two wires of the heating element and wrap them with high temperature insulation tape.



g. Install the mesh cover and install the wooden fence on the back.

## C.6 Oxygen Ionizer Installation

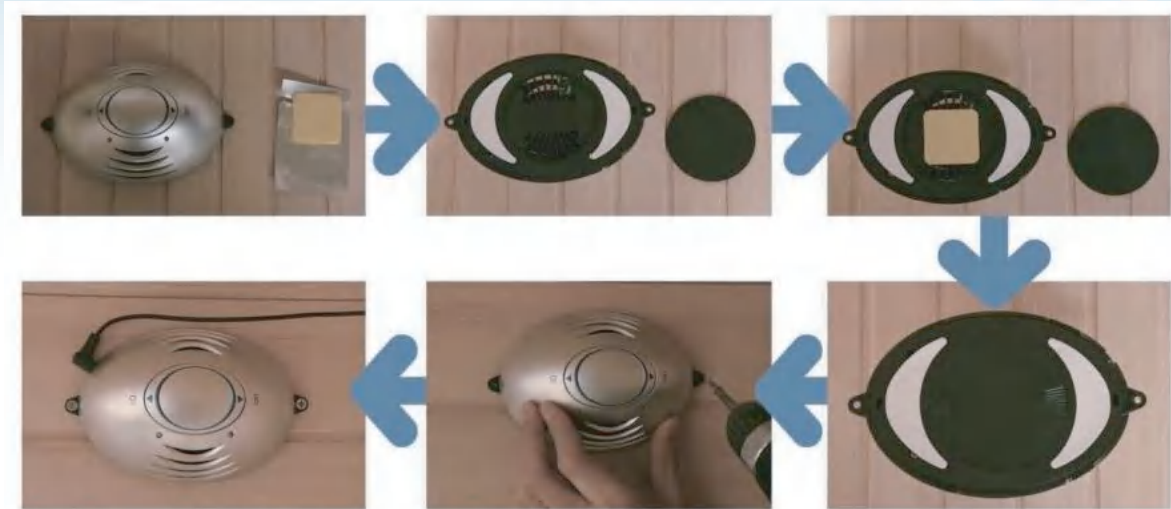

- Press the ion button: it extremely purifies the air and removes toxic substances including the dust odors and mold.
- Press the ozone button: ozone may kill virus, and will be oxidized into oxygen in the end without secondary pollution, which the chemical agents can not achieve.



### SPECIFICATION

MODEL: ----->DY13A  
 OZONE OUTPUT: ----->5MG/H  
 RATED VOLTAGE: ----->DC-12V  
 POWER CONSUMPTION: ----->5W  
 DIMENSION: ----->4.72"\*3.54"\*6.93"  
 ANION DENSITY: ----->1\*106PCS/CM<sup>3</sup>

- Operating instruction: anion and ozone can only work separately; when the ozone starts to work the anion will stop; after about 15 minutes working the ozone will stop; and turn the anion function automatically.

## D.OPERATION

**NOTE:** Before the sauna is turned on, remove plastic protective covering from the CONTROL PANELS. Please check and confirm that the connections to the POWER SUPPLY, HEAT EMITTERS, and TEMPERATURE SENSOR are connected properly. The power supply voltage and frequency must match the requested voltage and frequency of the sauna(120VAC 15AMP Dedicated Circuit).

### D.1 In use of sauna room

Please pull the temperature sensor vertical downward, as shown in the figure below to ensure the accuracy of the temperature display on control panel.



### D.2 Plug the power cord into the wall outlet.

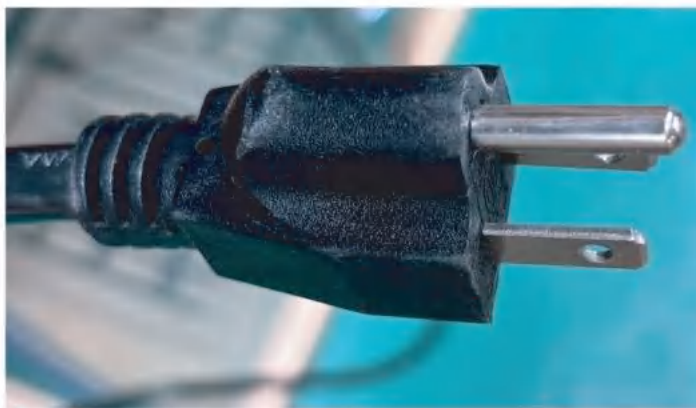

### D.3 Operation of control panel

a. Press the key . The power indicator turns on. Temperature display indicates the temperature in the room. Press the key again . The power indicator turns off.

b. Press the TIME Key or to adjust the time. If the time indicates 00, the room stops heating.

c. Press the TIME Key together can switch between C and F, the heat indicator turns on. The sauna will automatically start by pressing the key or on the left to adjust the temperature.

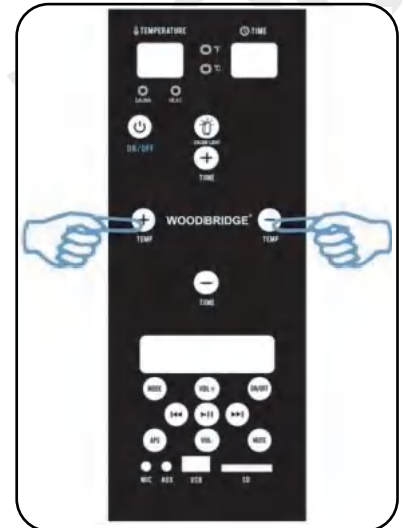
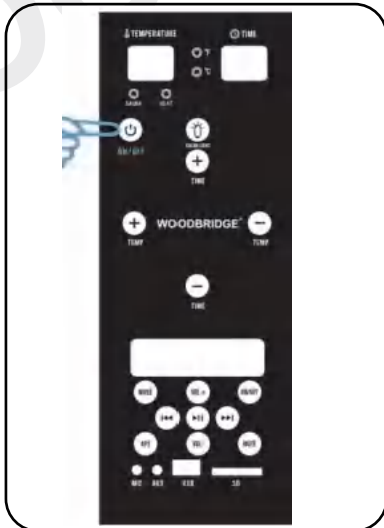

d. Press the key turn on LED color therapy light in the room, This light has 9 different kinds of effect. Pressing one time means one kind of color. Pressing L9, it turns into automatic quickly color changing mode and L8 it turns in to slowly color changing mode, and L1-L7 are for 7 different colors.

e. Press the key to turn on/off the music. Press the key to choose AM/FM and bluetooth (Bluetooth Name: G\_811). Press the key to choose the last song. Press the key to choose next song. Press the key to stop the song.

f. Press the Audio Control Key to increase the volume. Press the key to decrease the volume. Press the key and to answer the telephone.

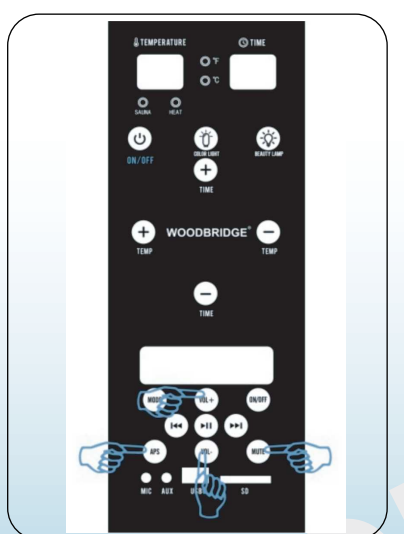
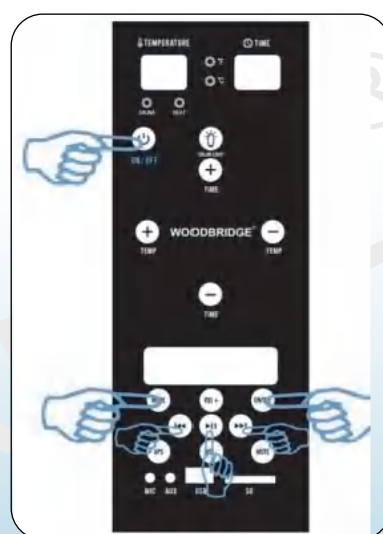
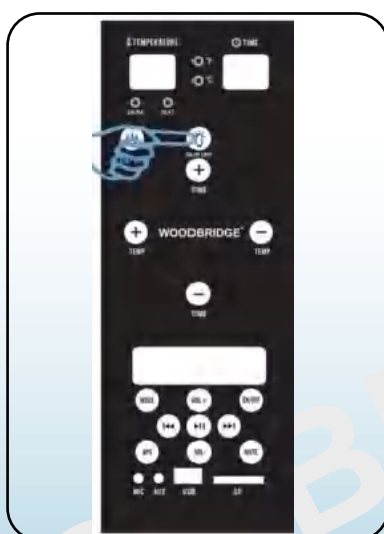

#### D.4 Open the ceiling vent to allow a flow of fresh if required.

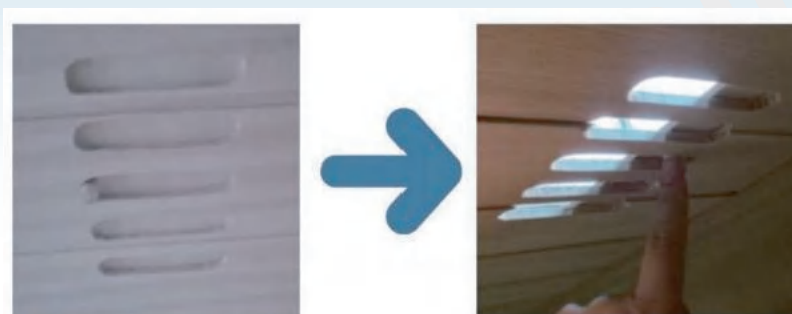

### E. TIPS FOR USE

- Set the temperature to a comfortable level, normally 40 to 50°C.(104 to 122°F)
- Allow approximately 8-15 minutes for the sauna to warm up.
- Perspiration will begin within 6 to 15 minutes after stepping into the unit. We recommend a sauna session does not exceed 30 minutes.
- When the temperature reaches the level set on the thermostat, the heaters will turn off and on periodically to maintain the desired temperature level inside the sauna.
- The front door/window/ceiling vent can be opened at any time to allow fresh air into the room.
- Drink plenty of water before, during and after a session to replenish lost fluids from the body.
- Taking a hot shower or bath before the sauna session will further accelerate perspiration. However, do dry off thoroughly before entering, for excessive water will stain or warp the wood.
- To absorb perspiration and keep the sauna tidy, place a towel on the bench and floor of the sauna. Keep one towel handy to wipe out sweat from the body.
- Do not eat at least an hour before your sauna session. It is better to go in a sauna with an empty stomach.
- Do not use the sauna immediately after a strenuous exercise.
- Any area you want to achieve a deep heating should be moved close to the heaters. But never allow any part of the body to come into direct contact with the heater.
- After the session is over, do not immediately get out. Let the body sweat a little more. Then, take a warm shower and finish it off with a cold shower to cool off completely.

## F.FREQUENTLY ASKED QUESTIONS

MAKE SURE TO SHUT OFF THE ELECTRICITY BEFORE DOING IT.

If the supply cord is damaged, it must be replaced by the manufacturer, its service agent or similarly, qualified persons in order to avoid a hazard.

### F.1 Heater has problem.

Problem	Explanation	Solution
Heaters are still working When set time is up.	Power board and control panel broken.	Replace with a new power board and control panel.
All or parts of heaters working before you turn on the power, when you plug the power cord.	Power board broken.	Replace with a new power board.

### F.2 The control panel does not work.

Problem	Explanation	Solution
The power indicator isn't on.	The fuse is broken or the sauna is not plugged in.	Change the fuse or the plug in the sauna.
The soft keys do not work.	Unplug sauna, wait a minute or plug back into power source.	

### F.3 The interior reading light doesn't work.

Problem	Solution
The bulb is burned out.	Change the bulb( $\leq 15$ watt)

### F.4 The carbon heater is not heating.(Warning: only qualified person can replace or repair the heater)

Problems	Explanation	Solution
Part of the heater does not warm up.	The heater is defective.	Replace with a new heater.
	Part of the heater is not connected well or burned out.	Connect them tightly.
The entire room does not heat.	The relay is damaged.	Replace the relay.
	The control panel is damaged.	Replace the control panel.
	The plug is not plugged in correctly.	Re-plug it.
Bench heater does not heat.	It is not connected tightly into the outlet on the back panel.	Connected tightly.

## G.MAINTENANCE

- Clean the sauna room with a soft wet cloth. NEVER use petrol, alcohol, benzene or any other such chemical to clean the unit.

## H.TRANSPORTATION AND STORAGE

- Avoid exposure to rain, snow or strong collisions during transport.
- Do not store in damp environments.

## I.LIMITED WARRANTY

- The warranty warrants the sauna to be free of defects in material and workmanship.

※Heaters-----12 months

※Workmanship-----12 months

※Electrical Components-----12 months

- This warranty extends only to the original retail purchaser of the sauna and terminates upon transfer of ownership. Freight charges to and from the customer are the responsibility of the customer. This includes freight charges for parts shipped to enable the services of your sauna.

- This warranty is void if the sauna has been altered, misused, or abused. Such instances shall include operation or maintenance of the sauna in deviation to the published instructions. The warranty extends only to the manufacturing defects and does not cover any damages resulting from mishandling of the product by the owner.

- Disclaimers

Woodbridge shall not be liable for loss of use of sauna or other Woodbridge products or other secondary or incidental or consequential costs, expense or damages-which may include the removal of permanent deck or other custom fixtures. Under no circumstances shall Woodbridge or any of its representatives be held liable for injury to any person or damage to any property, however arising. Specifications are subject to change without notice or obligation.

- This sauna is for INDOOR use only. Placing your sauna outdoors will VOID this warranty. Any damage due to exposure to outdoor elements such as rain, snow, sun, wind or extreme temperatures will not be covered by this warranty. Any damages as a result of modifications made to the sauna or its components will void this warranty. Surface cracks are not considered defects in material or workmanship, as they are normal characteristics of all woods. This includes minor cracks due to wood expansion and contraction.

**Note: Since the wood used in construction has been kiln dried, a certain amount of expansion and contraction occurs in the wood in a sauna environment.**

**Woodbridge warrants the following products as listed in below to be free from defects in material and workmanship, subjected to the limitations set forth in this limited warranty.**

- Bathtub, Whirlpool/Air Bubble Massage Tub, Cold Plunge, Wooden Tub: 1 Year limited to be free of defects in material and workmanship.
- Sauna room and Sauna Tent: 1 Year limited to be free of defects in material and workmanship.
- Toilet and Bidet: 1 Year limited to be free of defects in material and workmanship.
- Faucet: 1 Year limited to be free of defects in material and workmanship.
- Vanity and Vanity Top: 1 Year limited to be free of defects in material and workmanship.
- Granite, Marble, Engineered Quartz Vanity Top: 1 Year limited to be free of defects in material and workmanship.
- Medicine Cabinet, LED Mirror: 1 Year limited to be free of defects in material and workmanship.
- Stainless Steel Sink: 1 Year limited to be free of defects in material and workmanship.
- Solid Surface Shower Wall Panel, SMC Shower Base: 10 Years limited warranty to be free from material defects.
- Drain Cover and PVC Drain: 1 Year limited to be free of defects in material and workmanship.
- Shower Door: Lifetime warranty on glass components and 1 Year limited on other hardware.

**This limited warranty is non-transferable and only applies to products purchased and installed in the United States and Canada**

This limited warranty excludes all industrial, commercial and business usage. Proof of purchase (original sales receipt) from the original purchaser, Description and pictures of defect, model number or model description must be provided to Woodbridge Bath for all warranty claims and Woodbridge Bath IS NOT responsible for labor cost, removal or installation costs.

This limited warranty shall not apply to goods which have been subject to accident, negligence, improper installation, product abuse, product misuse, or use of cleaners containing abrasives, alcohol or other organic solvents, whether performed by a contractor, service company, or yourself, are excluded from this warranty.

This warranty does not cover surface damaged caused by use of chemicals that break through or dissolve the surface finish or damage caused by the accidental dropping of sharp or heavy objects. Improper care and use of abrasive cleaners and will void the warranty.

During this limited warranty period if a malfunction occurs and after inspection it is determined that a defect developed during normal use, Woodbridge reserves the right to take any of the following actions at its discretion:

- (1) **repair or replace the defective part(s) or product(s) at cost**
- (2) **issue a refund of the original purchase price of the product(s) (Valid within 30 days from the date of purchase)**
- (3) **issue a credit to be applied toward the purchase of a new product. Shipping or delivery charges may apply. Whether such charges are required, and the amount and conditions under which they apply, shall be determined solely at the discretion of Woodbridge.**

Caution:  
NEVER use cleaners containing abrasives, ammonia, bleach, acids, waxes, alcohol, solvents or other products not recommended for chrome finishes. Doing so will void the warranty.  
Woodbridge strongly recommends installation by a licensed and insured professional to ensure proper performance and safety.

## RESPONSIBILITIES OF OTHERS

Inspecting the unit prior to installation is the responsibility of the installer or building contractor who acts on behalf of the user. They are responsible for ensuring the unit is free of defect or damage. Notices are placed on the unit and on the shipping carton advising the installer of this responsibility. In the event of a problem, the unit must not be installed. Woodbridge is not responsible for failures or damage that could have been discovered, repaired, or avoided by proper inspection and testing prior to installation.

Damage occurring in transit is the responsibility of the carrier. The user or installer MUST open the crate and inspect the unit for damage when it is delivered. If damage is discovered, it must be reported immediately to the seller and the carrier in writing, and an inspection requested. Failure of the carrier to respond should be reported to the seller and the carrier. Your freight claims should be filed promptly thereafter.

This limited warranty does not cover any liability for consequential or incidental damages, all of which are hereby expressly disclaimed, or the extension beyond the duration of this limited warranty of any implied limited warranties, including those of merchantability or fitness for an intended purpose.

## DISCLAIMER

Except as expressly provided, there shall be no warranty or obligation, express or implied, oral or statutory. No dealer or other person has the authority to make any warranties or representations concerning or its products. In no event shall be held responsible for any such warranties or representations.

Some states/provinces do not allow limitations on how long an implied warranty lasts, or the exclusion on limitation of special, incidental or consequential damages, so these limitations and exclusions may not apply to you. This warranty gives you specific legal rights, you may also have other rights which vary from state/province to state/province.

**To obtain warranty and replacement parts, please send e-mail to [help@woodbridgebath.com](mailto:help@woodbridgebath.com) with the original receipt information, Woodbridge will determine whether to repair or replace your product, issue a refund or issue a credit.**

**IMPORTANT!**

**DO NOT USE:** Abrasive cleaners such as: acid, ammonia, bleach, and similar solutions. Use of such solutions may cause corrosion, finish peeling, and/or dull the surface.

**DO NOT USE:** Abrasive sponges or cloth. Never use steel, wool, or wired brushes that will permanently scratch the surface.

**Retain these installation instructions for future reference!**

Thank you for using WOODBRIDGE products!

**WOODBRIDGE®**

California (Norwalk) Centre de distribution  
15600 Blackburn Ave, Norwalk, CA 90650

New Jersey (Somerset) Centre de distribution  
635 Pierce St, Somerset, NJ 08873

Floride (Orlando) Centre de distribution  
13645 S Orange Ave, Orlando, FL 32824

Canada (Ontario) Centre de distribution  
615 Orwell Street, Unit C, Mississauga, ON L5A2W4, Canada

**SCAN  
ME**

To Activate  
Warranty



Please don't hesitate to contact us if you have any questions or concerns.

Customer Service Phone: 562-229-0088. (Monday - Friday 9 AM - 5 PM Pacific Standard Time)

Or Email: [help@woodbridgebath.com](mailto:help@woodbridgebath.com)

